



AD1400A

HIGH VOLUME CIRCULATION FAN

APPLICATION

Circulation fan suitable to create a uniform indoor climate and to recirculate air in dairy barns and greenhouses.

CONSTRUCTION

- Casing made from stainless steel to ensure full corrosion protection.
- Adjustable pitch aerofoil impellers are provided with blades made from high quality Glass Reinforced Polypropylene.
- Hubs manufactured from die cast aluminium alloy
- Assembled impellers to be dynamically balanced to ISO 14694 Grade G6.3.
- Conveyor made from technopolymer for ease of cleaning and not susceptible to corrosion.
- High efficiency three-phase EC brushless motor, 200-480Vac/3ph/50/60Hz, IP65, with integrated electronic system and EMC filters. Suitable for S1 continuous service. Speed controllable.
- Simplified electrical connection: precabled.

FEATURES & BENEFITS

- Mechanical ventilation unit ideal for in-line installation on the feed lane and on the rest/waiting area (the so-called "wind channel" ventilation).
- Effective in preventing thermal stress on the animals: it helps to increase the heat loss by removing the warm air layer surrounding the animal's body and to increase evaporation, with benefits for latent heat loss.
- Top silent operation thanks to the gearless motor and the special airfoil design.
- No ordinary maintenance.
- Robust stainless steel structure for long life.
- Impellers are factory set at an angle to provide maximum performance.
- Eyebolt hooks to simplify hanging and inclined installation
- Integrated EMC filters to prevent electromagnetic interference from other devices.
- Fan are suitable for operating temperatures from 0°C to +50°C.
- Simplified electrical connections, pre-wired cable with screw connectors that guarantee safety, reliability and waterproofness.
- Modbus interface
- Unit performances are tested to the latest standard meaning accurate information that can be relied upon.
- Designed and manufactured in accordance with Machinery Directive (MD), Low Voltage Directive (LVD), Electromagnetic Compatibility Directive (EMC).

ACCESSORIES

- Remote controllers
- Motor side guard in stainless steel.

AD1400A

Performance @ 400Vac 50Hz

Description	Fan diameter	Max Rotation Speed	Max Thrust	Max Electric power	Max Air Flow AMCA 230-15			Max Air Flow AMCA 230-99		
					cfm	m³/h	SPI W/(m³/s)	cfm	m³/h	SPI W/(m³/s)
AD1400A	1170	475	98	1040	19855	33733	111,0	28079	47706	78,5

Dimensions (mm) and Weight (kg)

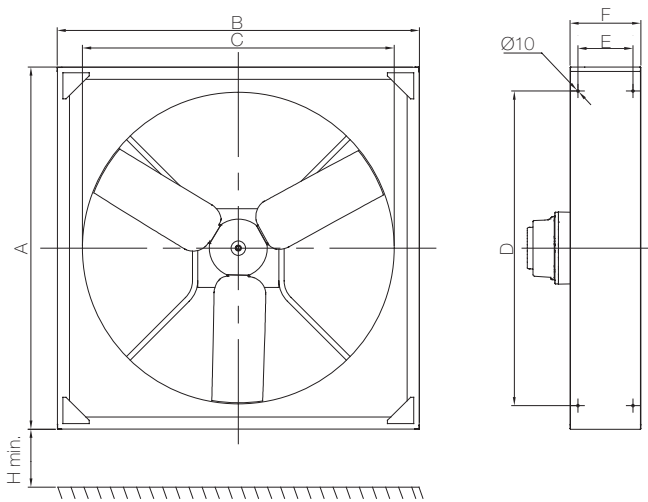



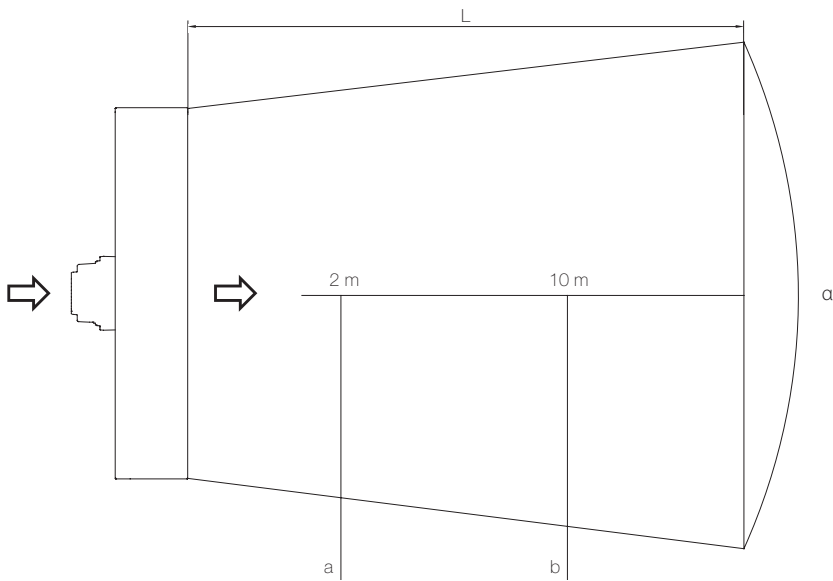

Description	A	B	C	D	E	F	H min.	Weight
AD1400A	1382	1382	1189	1200	210	270	2700	50

Velocity pattern

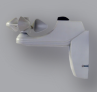

Description	Q [m³/h]		L @ air velocity = 0,2 m/s [m]	Air velocity @ 2m [m/s]	Air velocity (10m) [m/s]
AD1400A	33733	50°	27	5,6	2,4

Accessories

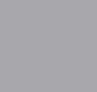
Description		CTRL-A		CTRL-XWS		AN-SY		SV-10K Temperature probe		CTRL-XTHI		YGRO-100 Humidity probe
	Description	Code	Description	Code	Description	Code	Description	Code	Description	Code	Description	Code
AD1400A	CTRL-A	002049	CTRL-XWS	005324	AN-SY Anemometer	002741	SV-10K	005327	CTRL-XTHI	005325	YGRO-100	005326

Description		Motor side bird guard	Impeller side bird guard		Motor side safety guard		Impeller side safety guard	
	Description	Code	Description	Code	Description	Code	Description	Code
AD1400A	Motor side bird guard	003613	Impeller side bird guard	005440	Motor side safety guard	005437	Impeller side safety guard	005439

CTRL-A



- Potentiometer with front knob to adjust the motor speed
- Provided with two-pole switch (ON/OFF)
- Front yellow led to indicate that the load is active
- Controls one fan only
- 230V~ 50/60Hz
- Supplied with IP55 wall surface box

CTRL-XWS



AN-SY

SV-10K

- To control the ventilation units according to temperature and wind speed.
- Three operating modes:
 - Mode A: control of ventilation according to wind speed by means of an anemometer (accessory on request) and blocking of the fan according to temperature
 - Mode B: control of ventilation according to room temperature using 1 temperature probe (supplied as standard) and blocking of the fan according to wind speed
 - Mode C: control of ventilation according to room temperature by means of 2 temperature probes (additional temperature probe on request) to manage winter destratification and summer comfort ventilation
- Regulation 0-10V
- 230Vac - 50/60Hz
- Can control up to 10 units
- IP65 wall-mounted casing
- Dimensions: 160x110x81 mm
- 1 temperature probe included
- Wind speed probe (anemometer) available on request
- Additional temperature probe for operating Mode C available on request

AD1400A

CTRL-XTHI



- To control the ventilation units according to temperature and THI level.
- Shower control and auxiliary ventilation activation.
- Regulation 0-10V
- 230Vac - 50/60Hz
- Can control up to 10 units
- IP65 wall-mounted casing
- Dimensions: 160x110x81 mm
- Temperature probe included
- Humidity probe available on request